

Ersatzteilverzeichnis
Spare Parts List

NP16/14-210
NP16/15-210
NP16/18-140
NP16/21-140

Best.-Nr.: 00.5089
Code Nr. 00.5090
00.5091
00.5092

| Lfd. Nr. Item No. | Stückzahl No. Off | Best.-Nr. Code No. | Benennung | Description |
|----------------------|----------------------|-----------------------|---|--|
| 1 | 1 | 01.0566 | Antriebsgehäuse | Crankcase |
| 2 | 1 | 00.4011 | Ölmeßstab | Oil Dipstick |
| 2 | 1 | 00.4049 | Ölmeßstab NP16/14 | Oil Dipstick NP16/14 |
| 3 | 1 | 03.0223 | Getriebedeckel | Crankcase Cover |
| 3A | 1 | 00.2372 | Ölablaßstopfen | Oil Drain Plug |
| 4 | 1 | 06.0539 | O-Ring | O-Ring |
| 5 | 1 | 00.3842 | Stopfen G3/8 | Plug G3/8 |
| 6 | 4 | 21.0069 | Innensechskantschraube | Hexagon Screw |
| 6A | 4 | 07.3052 | Federring | Spring Washer |
| 7 | 2 | 03.0229 | Lagerdeckel | Bearing Cover |
| 8 | 1 | 07.3248 | Ölschauglas | Oil Sight Glass |
| 9 | 1 | 06.0249 | O-Ring | O-Ring |
| 10 | 8 | 21.0028 | Sechskantschraube | Hexagon Screw |
| 11 | 1 | 06.0883 | Radialwellendichtung | Radial Shaft Seal |
| 12 | 2 | 05.0078 | Rillenkugellager | Grooved Ball Bearing |
| 13 | 1 | 11.0520 | Kurbelwelle NP16/15, NP16/18 | Crankshaft NP16/15, NP16/18 |
| 13 | 1 | 11.0551 | Kurbelwelle NP16/21 | Crankshaft NP16/21 |
| 13 | 1 | 11.0569 | Kurbelwelle NP16/14 | Crankshaft NP16/14 |
| 14 | 1 | 07.3049 | Paßfeder | Woodruff Key |
| 15 | 3 | 16.0036 | Gleitlagerpleuel | Connecting Rod |
| 16 | 3 | 00.3835 | Plunger kpl. NP16/14, NP16/15 | Plunger Assy NP16/14, NP16/15 |
| 16 | 3 | 00.3847 | Plunger kpl. NP16/18, NP16/21 | Plunger Assy NP16/18, NP16/21 |
| 16A | 3 | 11.0568 | Plunger | Plunger |
| 16B | 3 | 11.0589 | Plungerrohr NP16/14, NP16/15 | Plunger Pipe NP16/14, NP16/15 |
| 16B | 3 | 11.0614 | Plungerrohr NP16/18, NP16/21 | Plunger Pipe NP16/18, NP16/21 |
| 16C | 3 | 21.0351 | Spannschraube NP16/14, NP16/15 | Tension Screw NP16/14, NP16/15 |
| 16C | 3 | 21.0055 | Spannschraube NP16/18, NP16/21 | Tension Screw NP16/18, NP16/21 |
| 16D | 3 | 06.0306 | Cu-Dichtring NP16/14, NP16/15 | Copper Washer NP16/14, NP16/15 |
| 16D | 3 | 06.0096 | Cu-Dichtring NP16/18, NP16/21 | Copper Washer NP16/18, NP16/21 |
| 17 | 3 | 11.0714 | Kreuzkopfbolzen | Crosshead Pin |
| 17A | 6 | 07.3721 | Seegerring | Clip Ring |
| 18 | 3 | 06.1164 | O-Ring NP16/14, NP16/15, NP16/18 | O-Ring NP16/14, NP16/15, NP16/18 |
| o•19 | 3 | 06.1081 | Doppellippendichtung | Double Lip Seal |
| 20 | 3 | 07.2993 | Dichtungsaufnahme NP16/14, NP16/15 | Seal Adaptor NP16/14, NP16/15 |
| 20 | 3 | 07.2842 | Dichtungsaufnahme NP16/18, NP16/21 | Seal Adaptor NP16/18, NP16/21 |
| o•21 | 3 | 06.1183 | O-Ring | O-Ring |
| o•22 | 3 | 06.0279 | O-Ring | O-Ring |
| •23 | 3 | 06.1454 | Nutring NP16/14, NP16/15 (schwarz) | Grooved Seal NP16/14, NP16/15 (black) |
| o23 | 6 | 06.1436 | Nutring NP16/18, NP16/21 | Grooved Seal NP16/18, NP16/21 |
| •23A | 3 | 06.1297 | Nutring NP16/14, NP16/15 (braun) | Grooved Seal NP16/14, NP16/15 (brown) |
| 23A | 3 | 07.2843 | Distanzscheibe NP16/18, NP16/21 | Spacer Disc NP16/18, NP16/21 |
| •24 | 6 | 07.2116 | Stützring NP16/14, NP16/15 | Support Ring NP16/14, NP16/15 |
| o24 | 3 | 07.2717 | Stützring NP16/18, NP16/21 | Support Ring NP16/18, NP16/21 |
| 25 | 3 | 07.2515 | LRF-Ring NP16/14, NP16/15 | LRF-Ring NP16/14, NP16/15 |
| 25 | 3 | 07.2841 | LRF-Ring NP16/18, NP16/21 | LRF-Ring NP16/18, NP16/21 |
| 26 | 1 | 01.0781 | Ventilgehäuse NP16/14, NP16/15 | Valve Casing NP16/14, NP16/15 |
| 26 | 1 | 01.0792 | Ventilgehäuse NP16/18, NP16/21 | Valve Casing NP16/18, NP16/21 |
| ••27 | 6 | 07.1650 | Ventilsitz | Valve Seat |
| ••28 | 6 | 07.2173 | Ventilplatte | Valve Plate |
| ••29 | 6 | 07.2544 | Ventilfeder | Valve Spring |
| ••30 | 6 | 07.2157 | Federspannschale | Spring Tension Cap |
| ••31 | 6 | 06.0078 | O-Ring | O-Ring |
| 32 | 6 | 07.3557 | Stopfen | Plug |
| ••33 | 6 | 06.0758 | O-Ring | O-Ring |
| 34 | 6 | 21.0346 | Innensechskantschraube | Inner Hexagon Screw |
| 38 | 1 | 07.0608 | Stopfen G3/8 | Plug G3/8 |
| 39 | 1 | 07.0705 | Stopfen G1/2 | Plug G1/2 |
| 1 | 1 | 00.5114 | Antrieb NP16/14(1-22/23A/3x24/34) | Gear NP16/14 (1-22/23A/3x24/34) |
| 1 | 1 | 00.4248 | Antrieb NP16/15(1-22/23A/3x24/34) | Gear NP16/15 (1-22/23A/3x24/34) |
| 1 | 1 | 00.3910 | Antrieb NP16/18(1-22,3x23/34) | Gear NP16/18 (1-22,3x23/34) |
| 1 | 1 | 00.3911 | Antrieb NP16/21(1-22,3x23/34) | Gear NP16/21 (1-22,3x23/34) |
| 1 | 1 | 00.5094 | Pumpenkopf kpl. NP16/14, NP16/15 (23/3x24/25-33/38/39) | Pump Head Assy NP16/14, NP16/15 (23/3x24/25-33/38/39) |
| 1 | 1 | 00.5095 | Pumpenkopf kpl. NP16/18, NP16/21 (3x23/23A-33/38/39) | Pump Head Assy NP16/18, NP16/21 (3x23/23A-33/38/39) |
| 6 | 6 | 00.1909 | Ventil kpl. (27-30) | Valve Assy (27-30) |
| • | 1 | 14.0454 | Rep. Satz Dichtungen NP16/14, NP16/15 | Seal Repair Kit NP16/14, NP16/15 |
| o | 1 | 14.0406 | Rep. Satz Dichtungen NP16/18, NP16/21 | Seal Repair Kit NP16/18, NP16/21 |
| •• | 1 | 14.0364 | Rep.Satz Ventile | Valve Repair Kit |

Bei Bestellung von Ersatzteilen bitte Bestell-Nr., Pumpen-Nr. und -type angeben
When ordering please state Code No., Pump Model and Pump Serial No.

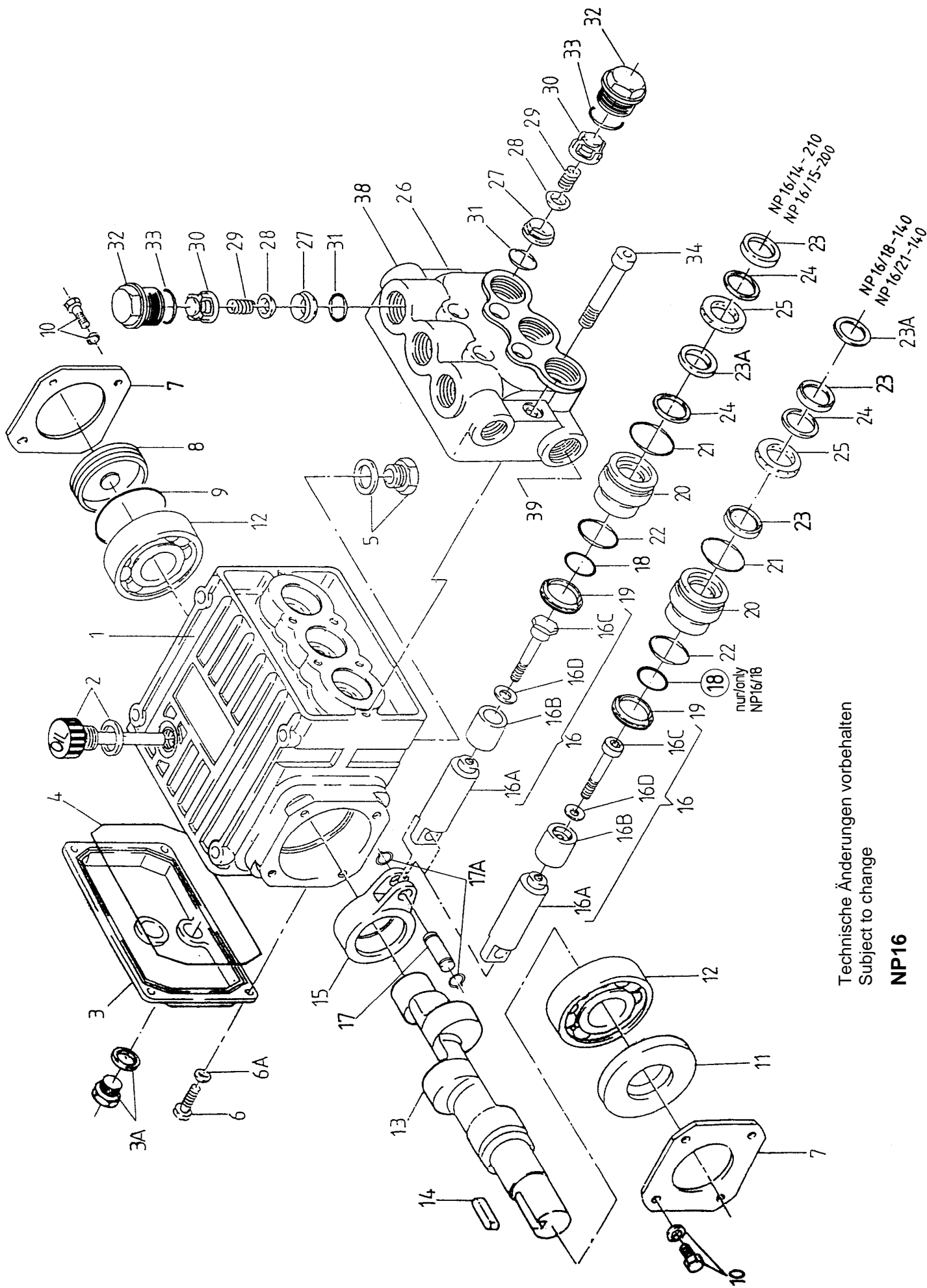

Technische Änderungen vorbehalten
Subject to change

NP16